

sāanvi
nirman



CITY GATE
COHESIVE BUSINESS COMMUNE

**GREAT
AMBITIONS
NEED A
GREATER
START!**

MANY AMBITIONS. ONE COHESIVE COMMUNE.

Established with the singular aim of enriching the lives of people with opulence, Saanvi Nirman thrives on the pillars of reliability, responsibility & professionalism. After making exceptional residential properties like Skydeck and Skysol, Saanvi Nirman brings to you City Gate, a cohesive business commune, where all the ambitious professionals can congregate, connect and grow together.

Designed to be an interconnected ecosystem with a single passion to achieve success, aided with ultra modern facilities, Saanvi Nirman's City Gate makes your time doing business profitably. Because great ambitions require a greater start!

**BOOK YOUR
AMBITIONS TODAY!**

**OFFICE SPACES STARTING
FROM 139 SQ.FT. (Carpet area)**



DOCTORS
who want a clinic that
gives a healthy growth.



**TRAVEL
AGENTS**
who want a destination
for success.

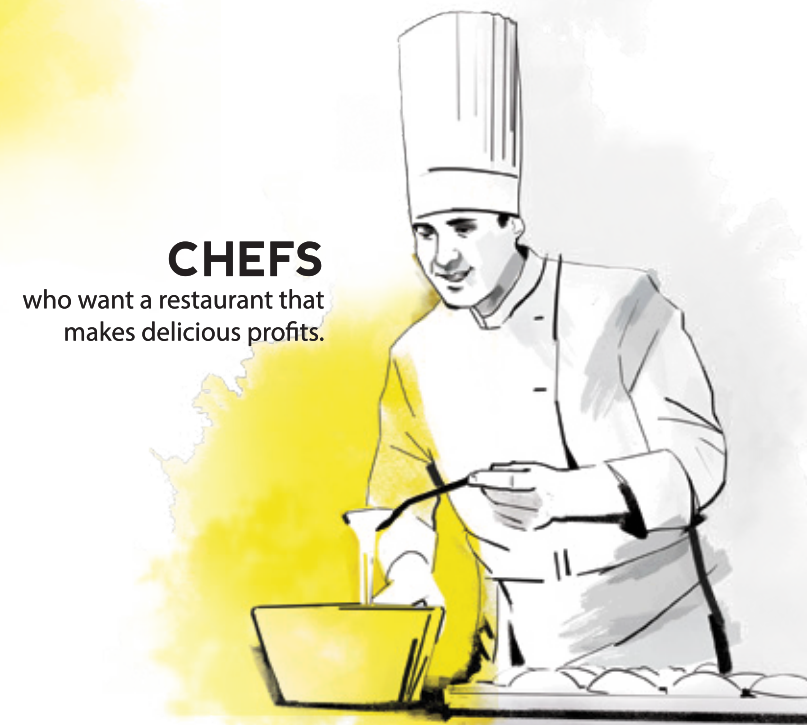

CHEFS
who want a restaurant that
makes delicious profits.



TUTORS
who want classrooms
that create winners.

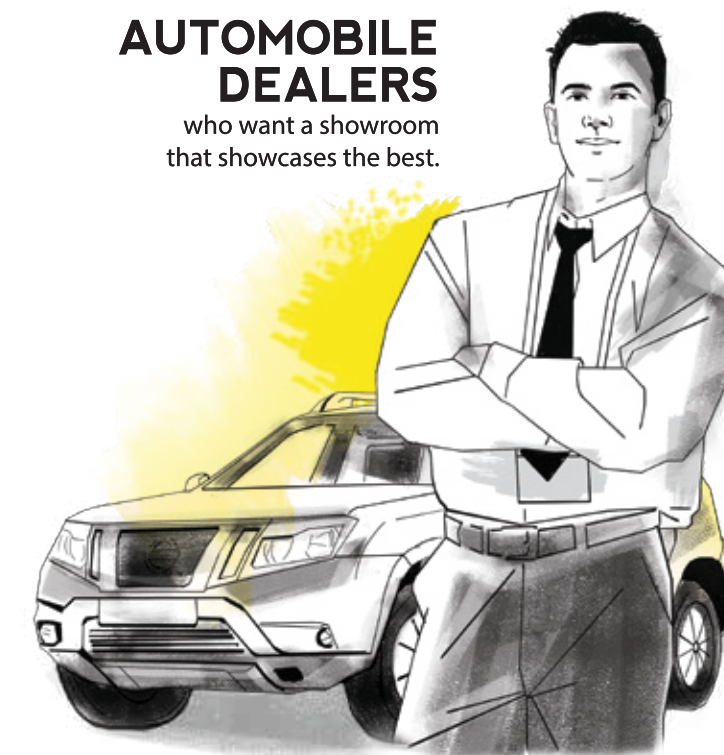

**AUTOMOBILE
DEALERS**
who want a showroom
that showcases the best.

GIVING GROWTH A HEAD START



IN THE COMFORT OF CONVENIENCE



AN ELEVATION TO MATCH AMBITIONS



CONNECTED TO BOOST SUCCESS



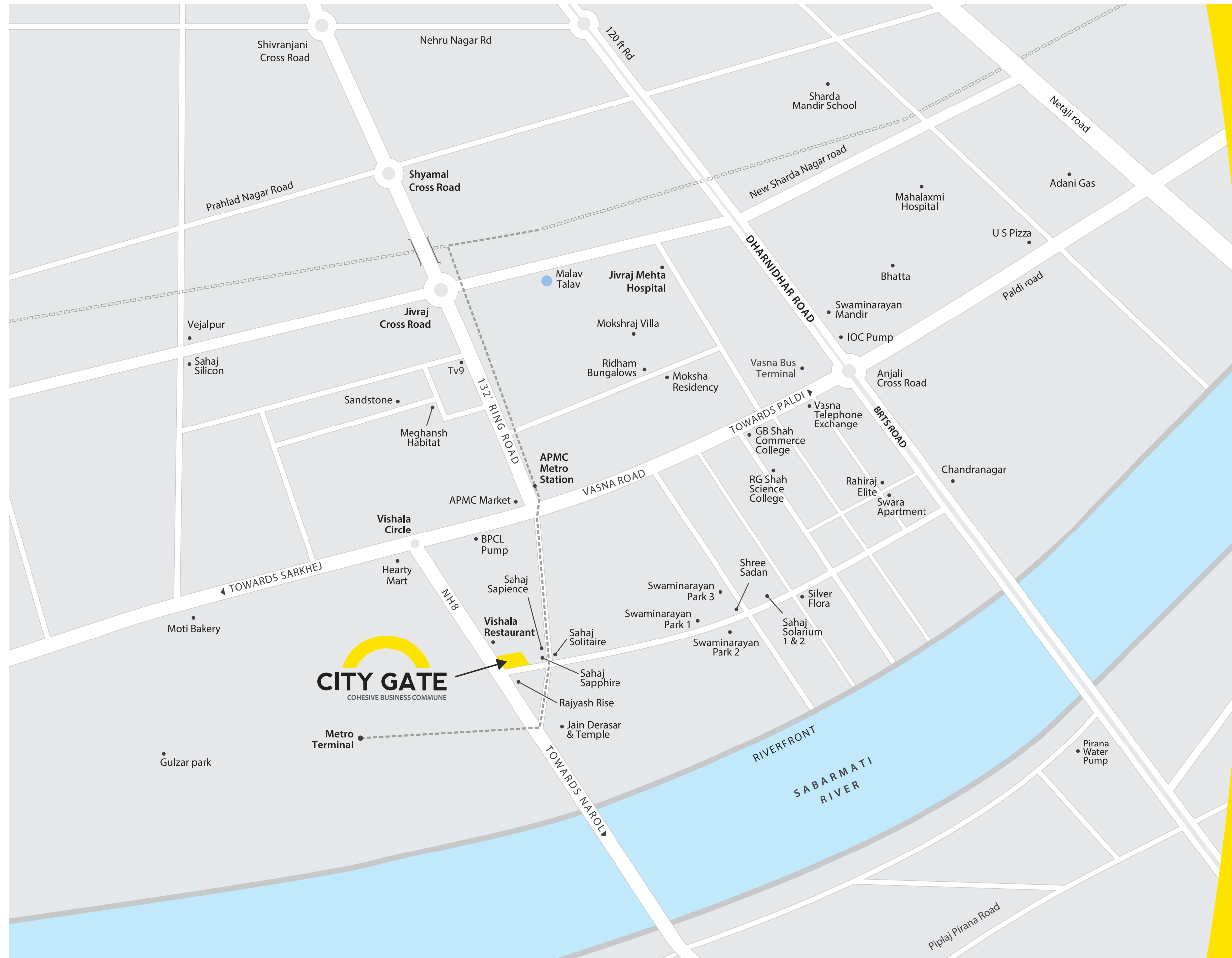

A HUB OF DREAMS IN THE HEART OF OPPORTUNITIES!

- Right next to Vishala Restaurant
- 700 m from APMC Market
- 800 m from APMC Metro Station
- 5 Km from Sarkhej
- 4 Km from Shivranjani
- 2.1 Km from Vasna Bus Stand
- 4.5 Km from Paldi



18 MT. ROAD



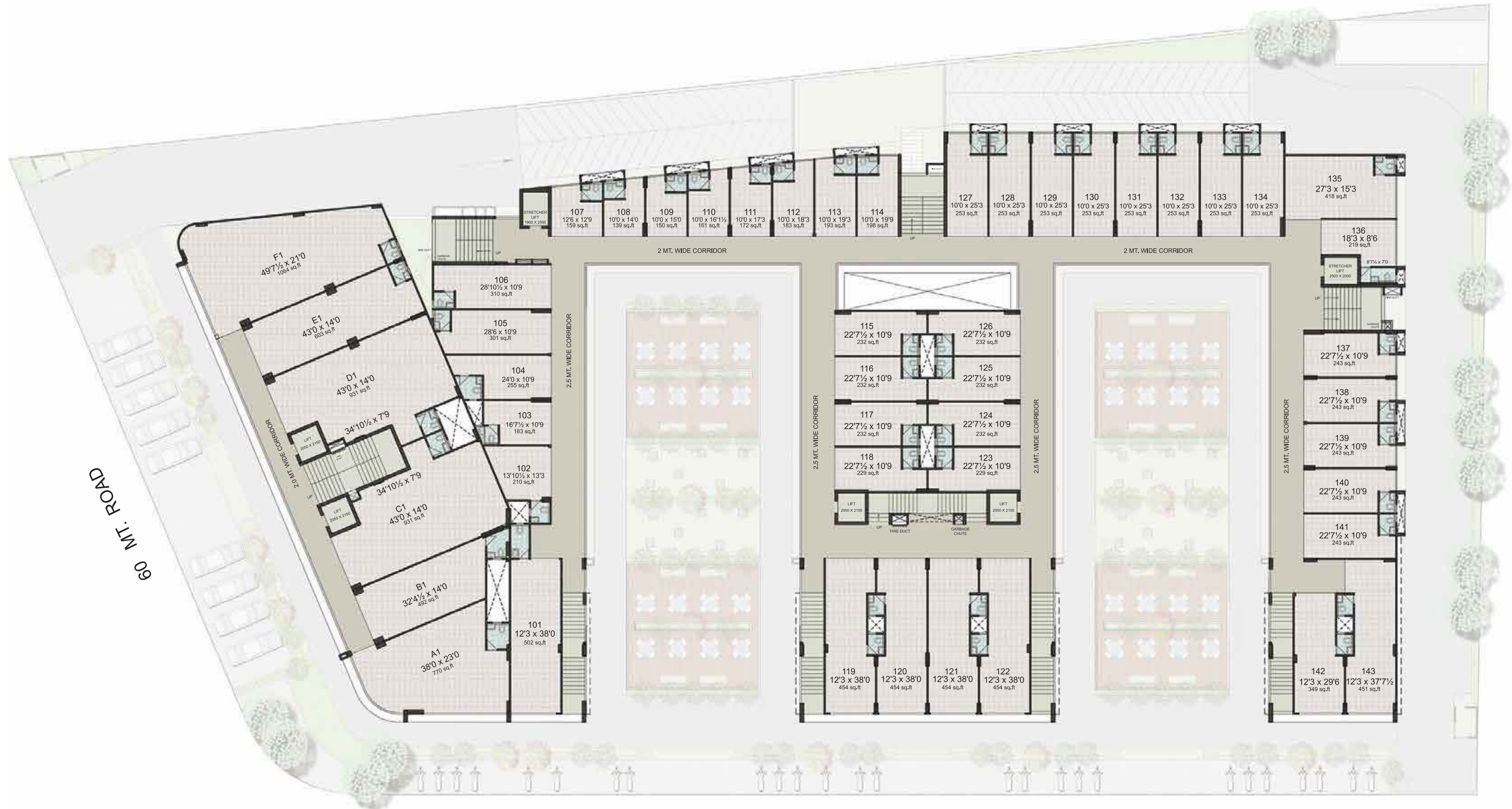

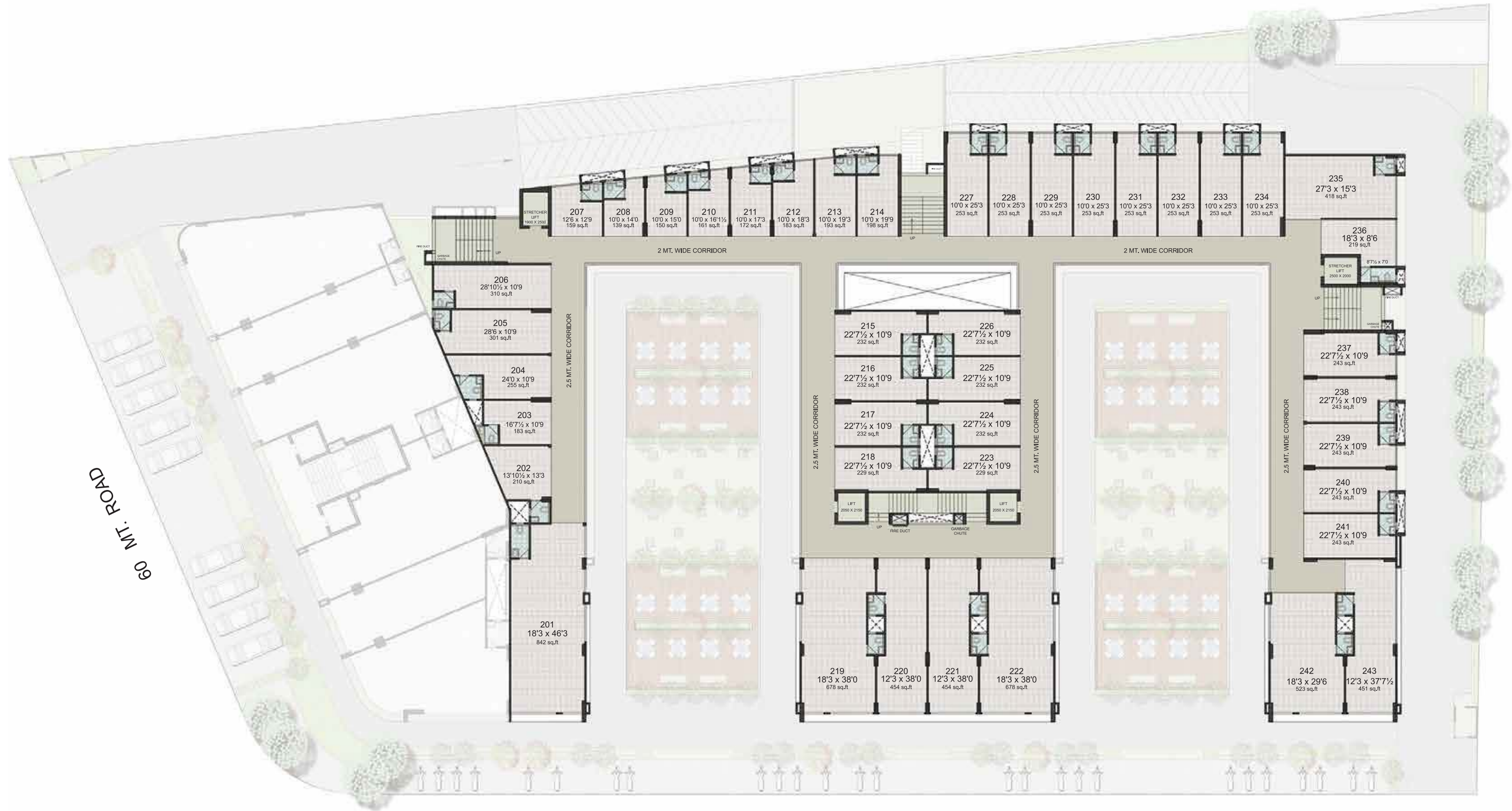

18 MT. ROAD



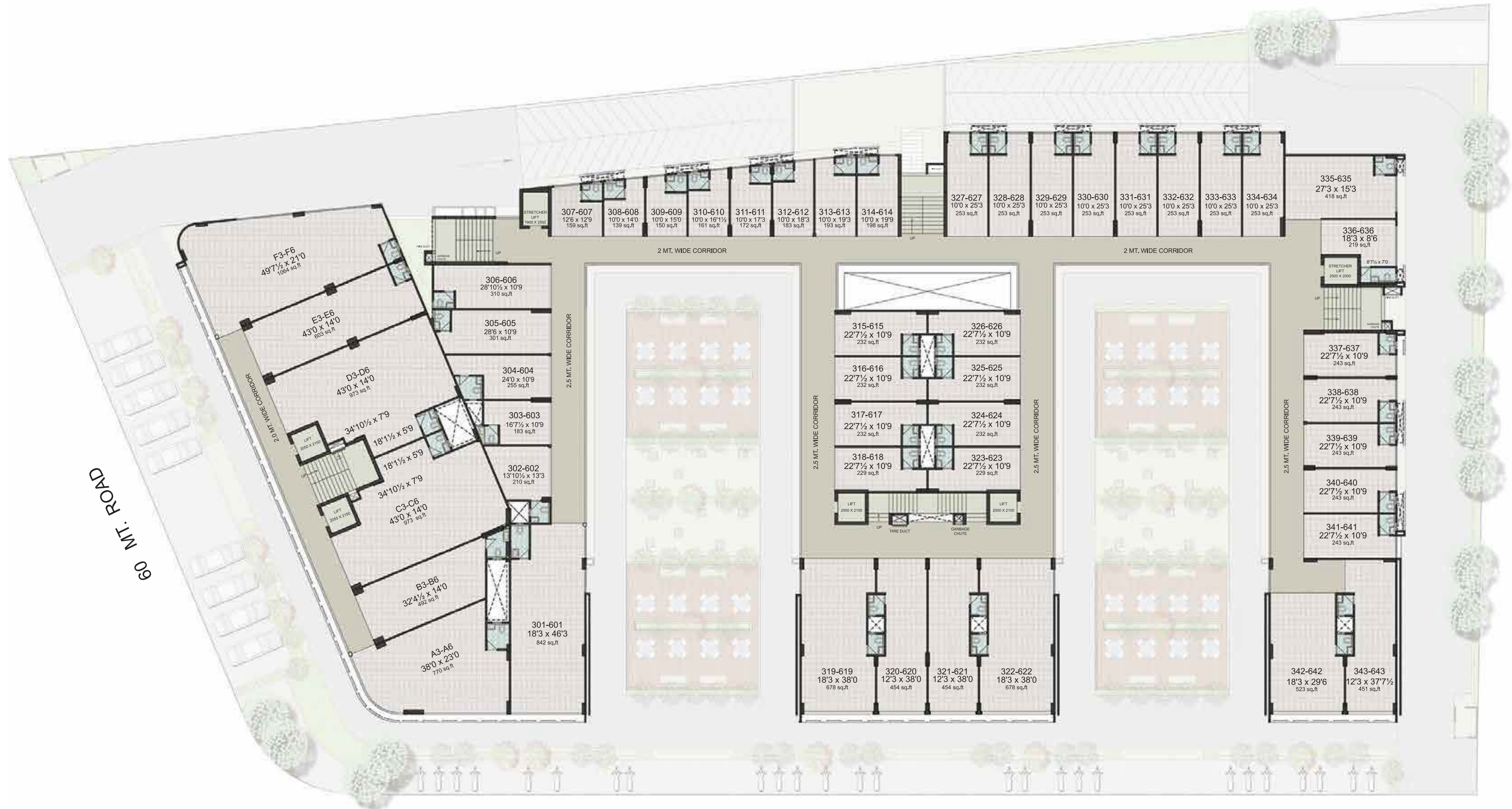



ENHANCING EASE THROUGH AMENITIES!

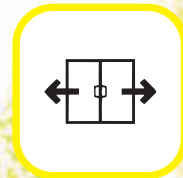

6 Premium quality automatic elevators (Two stretcher / service elevator)

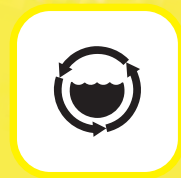

Equipped for rain water harvesting & grey water recycling



Maintained by house keeping professionals



Well planned landscape gardens



Ample parking space



Restroom on ground floor



Attached washroom with each unit

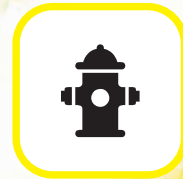

Fire hydrant system in each block



Fire sprinkler system with pipeline



24x7 CCTV surveillance

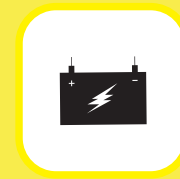

DG back-up for common areas

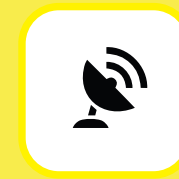

Provision for satellite connection



Well designed central atrium



Sanitation facilities for disabled



Fire & panic alarm on each floor



Provision for signage for each unit



Energy efficient building



Cafeteria

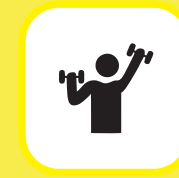

Gym



Conference hall

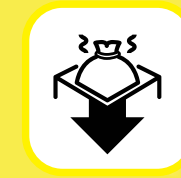

Garbage chute

SPECIFICATIONS



Wooden flush doors & good quality rolling shutters

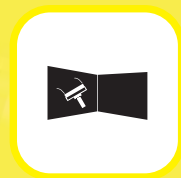

Internal walls putty finish & texture/ apex paint in common areas



Glazed tiles & good quality CP fittings in bathrooms



Concealed copper wiring with modular switches



Anodized aluminium section windows

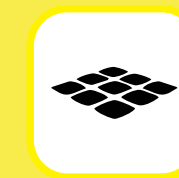

Vitrified tiles flooring



SITE ADDRESS

Next to Vishala Restaurant, New Vasna, NH 8, Ahmedabad-55

FOR INQUIRY

Vijay Desai: 84017 80581 • Email: vijay@saanvinirman.com
Ashish Jain: 75750 04878 • Email: ashish@saanvinirman.com